

Kuhn

SCHEDULE "A"

783

ALL that certain lot, piece or parcel of land and premises situate, lying and being on the Northern side of the Greenville Road, at Brooklyn, in the County of Yarmouth and Province of Nova Scotia, and more particularly shown on a Plan of Survey prepared by David S. Thorne Surveys Associates Limited dated December 3, 1985 and more particularly bounded and described as follows:

BEGINNING at a point on the Northeastern side of the Greenville Road at a placed survey marker and a Southwestern corner bound of land of Gordon White;

THENCE North Forty-one degrees Zero Zero minutes Zero Zero seconds West (N 41° 00' 00" W) following the Greenville Road One Hundred and Fifteen point Five Zero (115.50') feet to a placed survey marker and other lands of Gordon White;

THENCE North Forty-five degrees Twenty-four minutes Forty-two seconds East (N 45° 24' 42" E) following other lands of Gordon White Ninety-nine (99') feet to a placed survey marker;

THENCE South Forty-one degrees Zero Zero minutes Zero Zero seconds East (S 41° 00' 00" E) following lands of Gordon White One Hundred and Fifteen point Five Zero (115') feet to a large hole;

THENCE South Forty-five degrees Twenty-four minutes Forty-two seconds West (S 45° 24' 24" W) following lands of Gordon White Ninety-nine (99') feet to the first mentioned placed survey marker, the Northeastern side of the Greenville Road and the place of beginning;

CONTAINING an area of 11,412 square feet;

ALSO BEING AND INTENDED TO BE the same lands and premises as were conveyed by Lennie Thibeault to Dorothy Gertrude Kuhn by Deed dated July 9, 1980 and recorded at the Registry of Deeds office at Yarmouth, Nova Scotia on July 28, 1980 in Book MM, Page 436. The description having changed as a result of the aforementioned survey by D. S. Thorne Survey Associates Limited.

Plan #3217

PROPERTY Online NOVA SCOTIA

Property Online Map

Date: Dec 12, 2022 9:15:02 AM

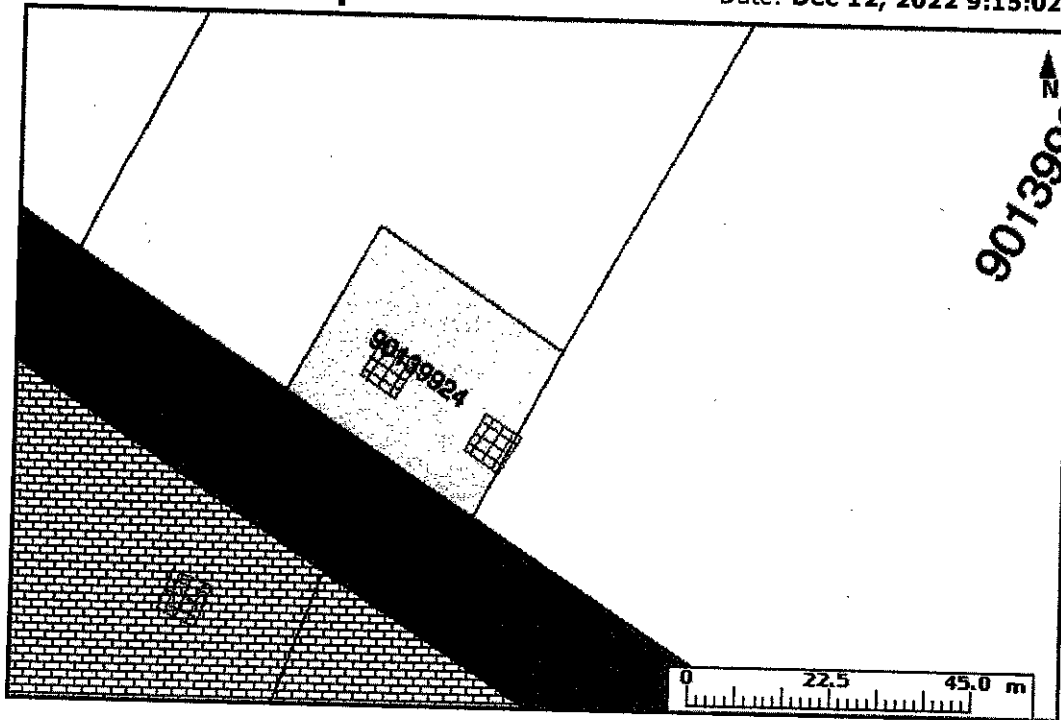

PID: 90139924	Owner: DAVID W KUHN	AAN: 04582322
County: YARMOUTH COUNTY	Address: 980 GREENVILLE ROAD	Value: \$20,800 (2022 RESIDENTIAL TAXABLE)
LR Status: NOT LAND REGISTRATION	BROOKLYN	

The Provincial mapping is a graphical representation of property boundaries which approximate the size, configuration and location of parcels. Care has been taken to ensure the best possible quality, however, this map is not a land survey and is not intended to be used for legal descriptions or to calculate exact dimensions or area. The Provincial mapping is not conclusive as to the location, boundaries or extent of a parcel [*Land Registration Act* subsection 21(2)]. THIS IS NOT AN OFFICIAL RECORD.

Property Online version 2.0

This page and all contents are copyright © 1999-2003, Government of Nova Scotia, all rights reserved.